

UP CONVENTION CENTER & GRAND BALLROOM

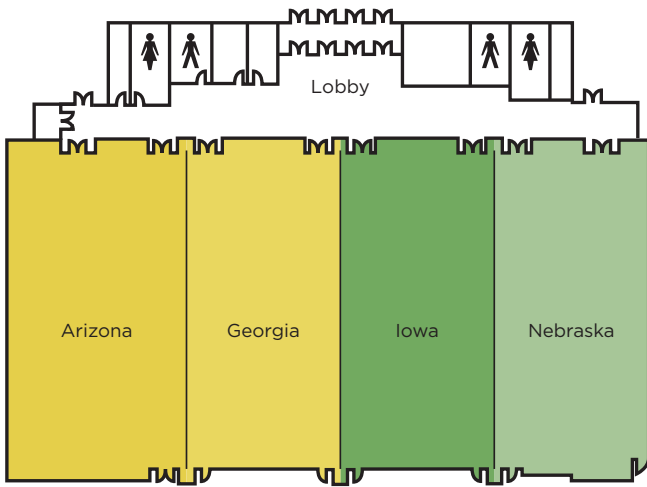

Convention Center

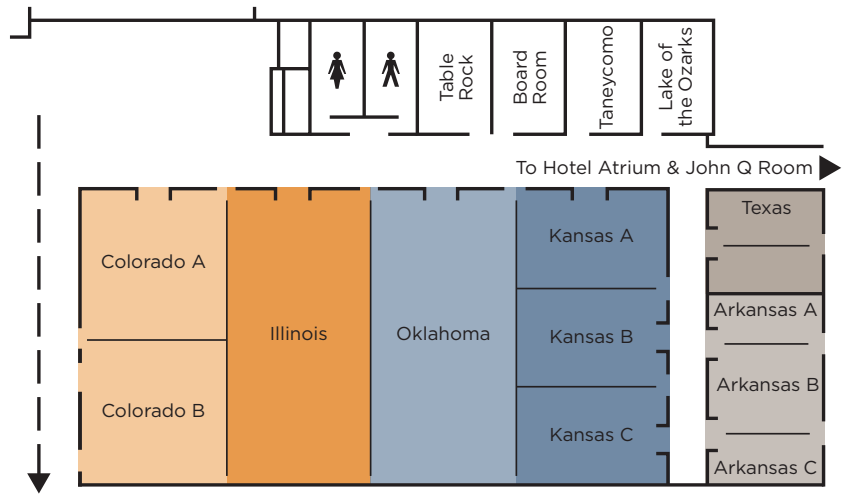

Grand Ballroom

Room	Square Footage	Length x Width	Ceiling Height	Largest Entry	Rounds of 10	Banquet	Classroom	Theater
Grand Ballroom	12,800	160'x80'	17'4"	12	780	1,200	690	1,500
Colorado (all)	3,200	40'x80'	13'4"	12	180	300	140	350
Colorado A or B	1,600	40'x80'	13'4"	12	90	150	70	150
Illinois	3,200	40'x80'	17'4"	12	180	300	140	350
Oklahoma	3,200	40'x80'	17'4"	12	180	300	140	350
Kansas (all)	3,200	40'x80'	13'4"	12	180	300	140	350
Kansas A, B, or C	1,067	26'8"x40"	13'4"	12	60	80	50	90
Kansas A&B, B&C	2,134	53'4"x40'	13'4"	12	120	170	100	210
Texas	793	27'8"x29'	9'	3	50	60	40	65
Arkansas (all)	1,274	49'26'	10'	3	80	120	72	100
Arkansas A or C	312	12'x26'	10'	3	20	30	20	25
Arkansas B	650	25'x26'	10'	3	40	60	32	50
Convention Center	21,600	108'x200'	18'	16	1,800	1,920	1,080	2,200
Arizona	5,400	108'x50'	18'	6	360	480	270	550
Georgia	5,400	108'x50'	18'	6	360	480	270	550
Iowa	5,400	108x50'	18'	6	360	480	270	550
Nebraska	5,400	108x50'	18'	16	360	480	270	550
John Q's	1,620	45'x36'	11'	12	140	150	84	175
Hospitality Suites (3 total)			10'	N/A	30	N/A	N/A	40

Boardroom fixed seating for 14

EXPO CENTER

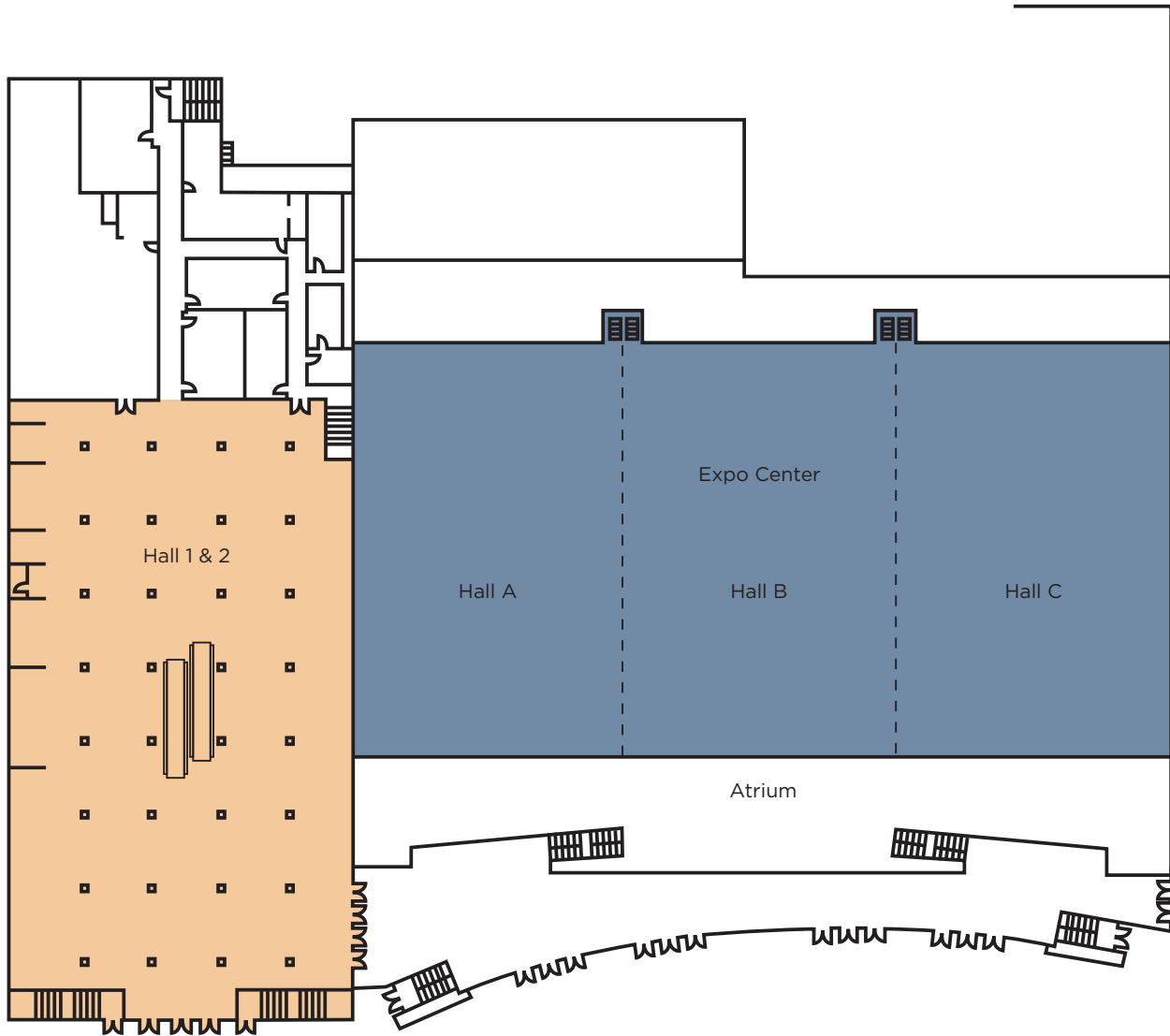

- 112,000 square feet of floor space to be used for consumer and public shows, boat shows, auto shows, sporting events, concerts and dances
- Can accommodate 543 8'x10' booths
- Tractor/trailer loading docks and entrance exhibit floor

- 22 3-phase electrical
- 35-foot ceiling
- Phone lines
- Dataports
- Pipe and drape
- Concession areas
- On-site catering
- Two Show Manager offices

Room	Square Footage	Length x Width (in feet)	Ceiling Height (in feet)	Rounds of 10	Classroom	Theatre	Booths
Expo Center	45,000	296x150	35	3,500	3,800	4,500	286
Expo Center A, B, or C	14,700	98x150	35	1,000	1,200	2,000	A-91, B-104, C-91
Expo Center A/B, B/C	29,400	196x150	35	2,000	2,500	4,300	169
Hall 2 (street level)	21,500	215x100	14	N/A	N/A	N/A	116
Hall 1 (lower level)	25,200	201x125	10	N/A	N/A	N/A	141
Breakouts (7 total)	625	25x25	14	40	30	50	N/A

THE AREA

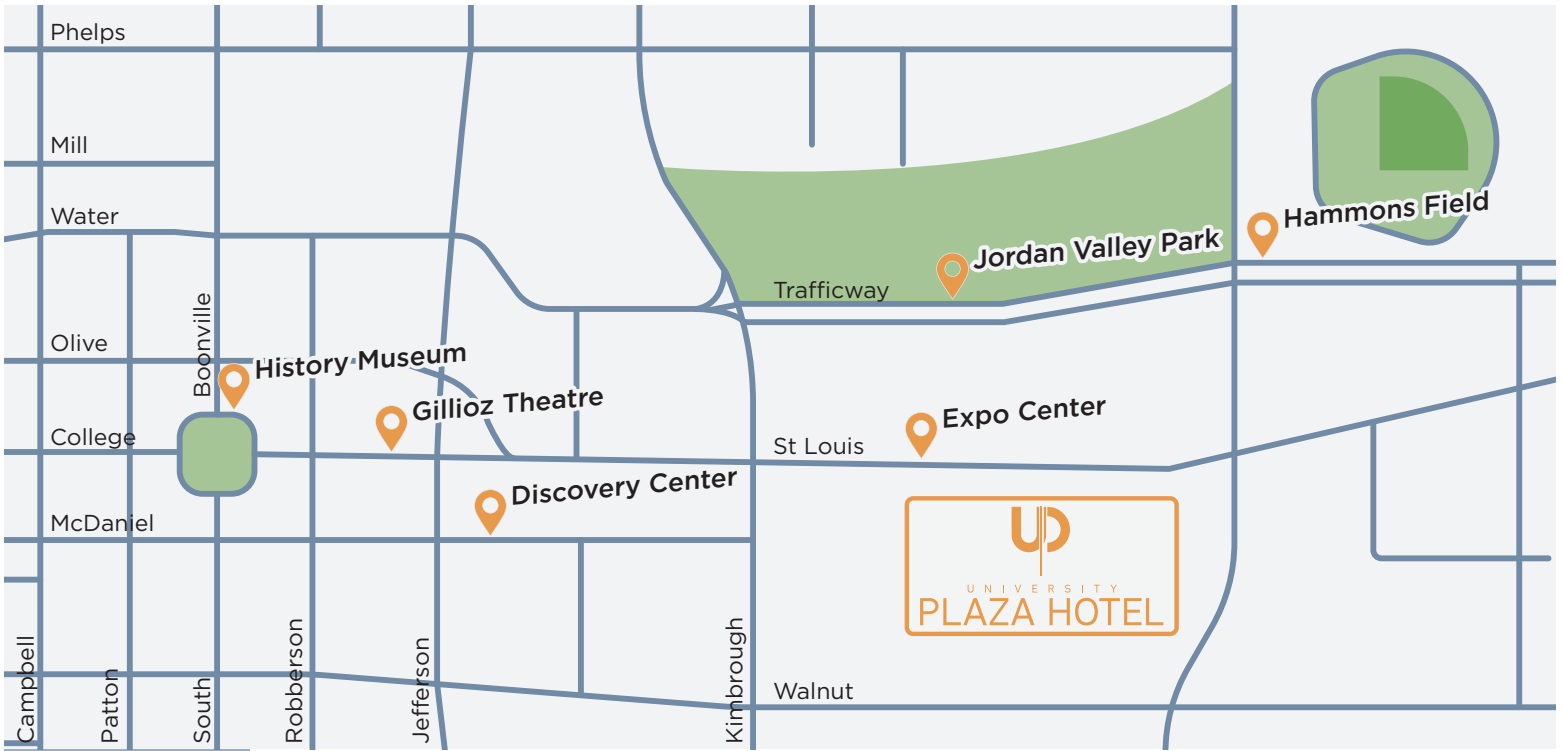

Downtown
Central

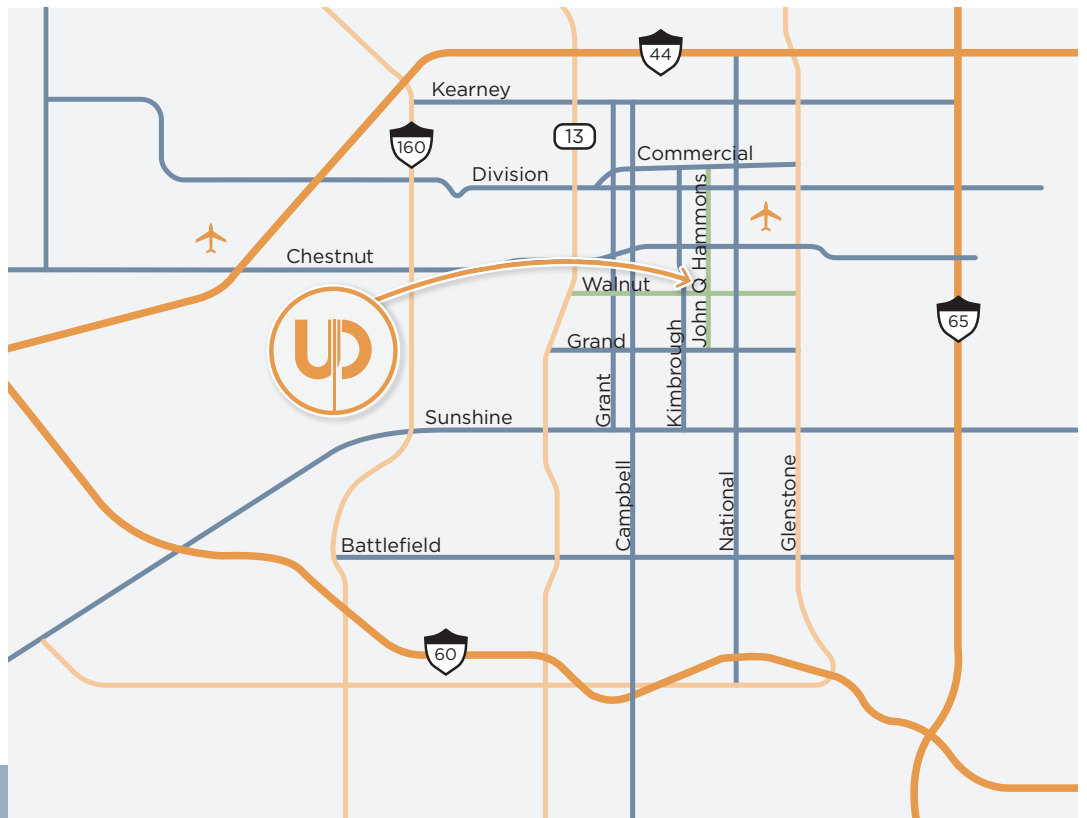

The City